

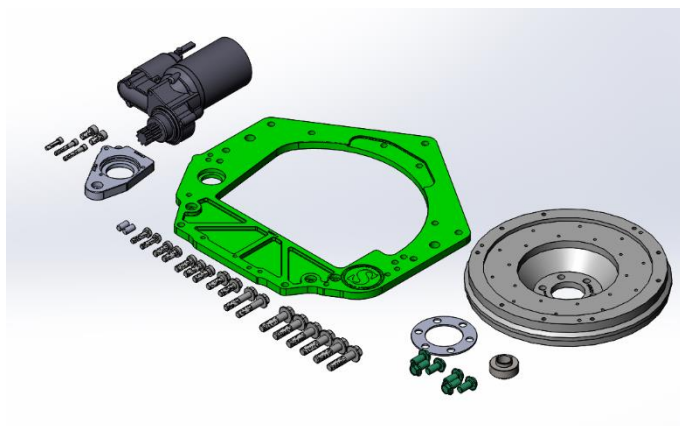

CD00X DE to LS Trans Adapter Plate Installation Guide

PN: TAK002 CG-006

This install guide is intended to be used as a reference when installing the Sikky CD00x DE adapter plate kit onto a Chevrolet LSx engine. This kit will work with CD001-CD009 as well as CD00A.



Included Components:

- Transmission Adapter Plate
- Pilot Bearing Adapter
- Flywheel
- Flywheel Bolt Plate
- Starter Block
- Starter
- Hardware Kit

Installation steps:

1. Remove the square casting lug from the engine block located at the bell housing side of the engine where the starter bolts. See attached image for location. This lug will interfere with the starter and needs to be removed. A Sawzall or cutoff wheel is an easy way to do so or whatever available option you have.



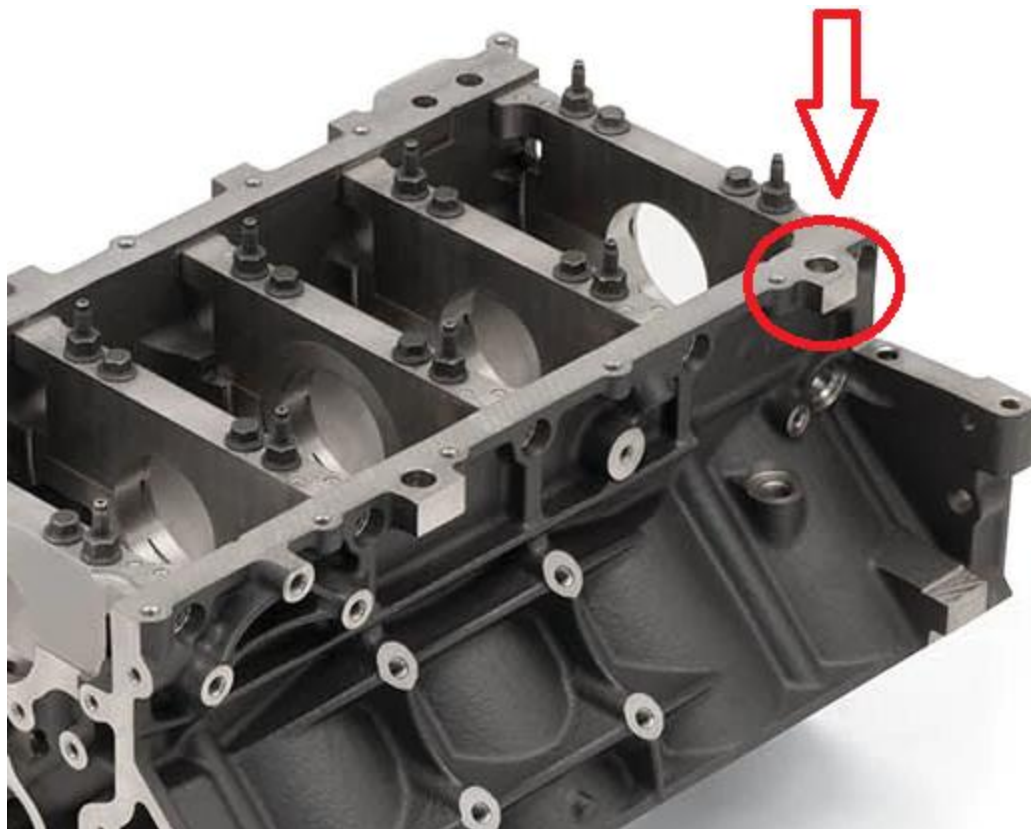

2. Bolt the Adapter Plate to the LS Engine Block using the (3) M10x1.5 Low Profile Socket Head Cap Screws and (2) M10x1.5 Flanged Hex Head Screws. These bolts require a 7mm Hex Key and a 15mm Socket.

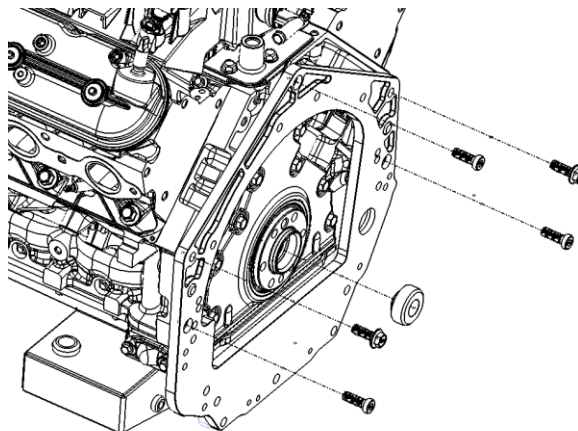

3. Press the Pilot Bearing Adapter into the LS Engine Block. Start slow and make sure the Adapter is going in square before driving it in flush.

4. Use a $3/16$ " hex key to bolt the Starter to the Starter Block using the (2) $1/4$ "-20 x 1.5" bolts and (1) $1/4$ -28 x 1" bolt.

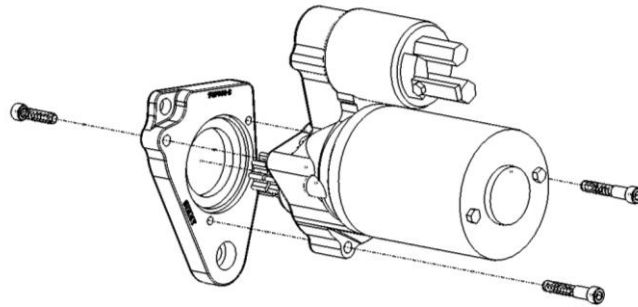

5. Bolt the Starter and Starter Block to the Adapter Plate using a $5/16$ " hex key and the (2) $3/8$ "-16 x $3/4$ " bolts.

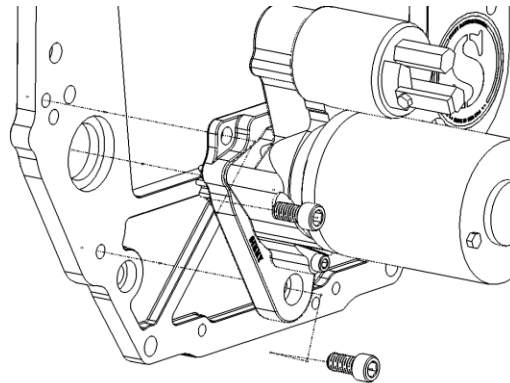

6. Bolt the flywheel to the LS Engine Block using a $\frac{3}{4}$ " 12-point socket and 6 ARP flywheel bolts if purchased with the kit. If you did not purchase the ARP bolts follow the torque spec of the bolts you will be using. Add RTV silicone sealant to the flywheel bolts to prevent any oil from leaking out from the crankcase. Tighten the bolts by hand until they are snug, then tighten each of them to 15ft-lbs in a crisscross pattern. Follow this by 36ft-lbs and finally 74ft-lbs, continuing the crisscross pattern.

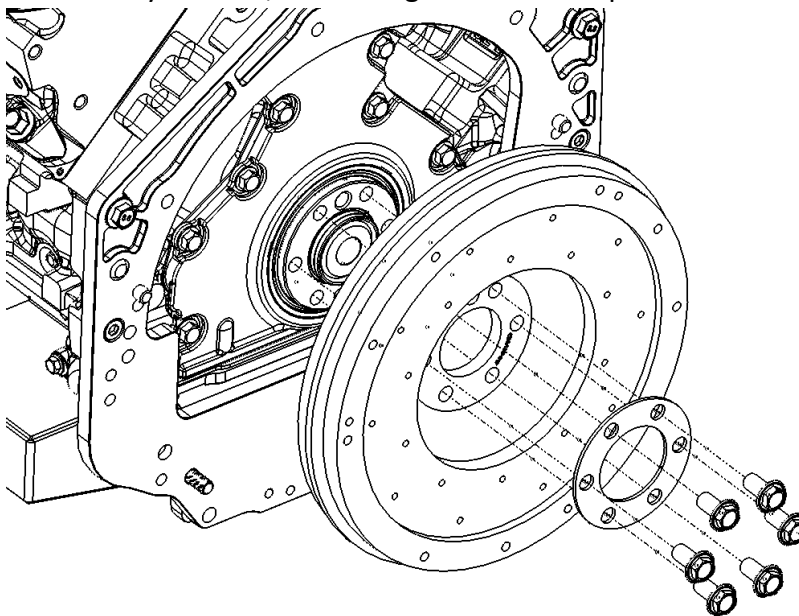

7. Clean the flywheel surface from any oil residues by spraying it with brake clean (or similar cleaning spray) and wiping it down with a cloth.
8. Install the three provided flywheel dowel pins for the pressure plate.
9. Install your clutch disc and pressure plate. Be sure to add Loctite to the pressure plate bolts and install these bolts in a similar crisscross pattern as the flywheel bolts. Use a torque wrench to tighten these bolts starting at 7 ft-lbs., then 18 ft-lbs., then 30 ft-lbs., following the crisscross pattern. (Any single clutch disc and pressure plate originally designed for use on a 350z or 370z will work)



10. Before installing the transmission there is a small area on the inside of the bellhousing that needs to be cleared slightly where the flywheel teeth will make slight contact. It's located where the clutch slave cylinder is bolted. See picture below for reference



11. Insert the (2) dowel pins into the bottom dowel pin hole for the CD00X DE transmission.
(note picture below shows top position which is for HR/JK trans not the DE version)

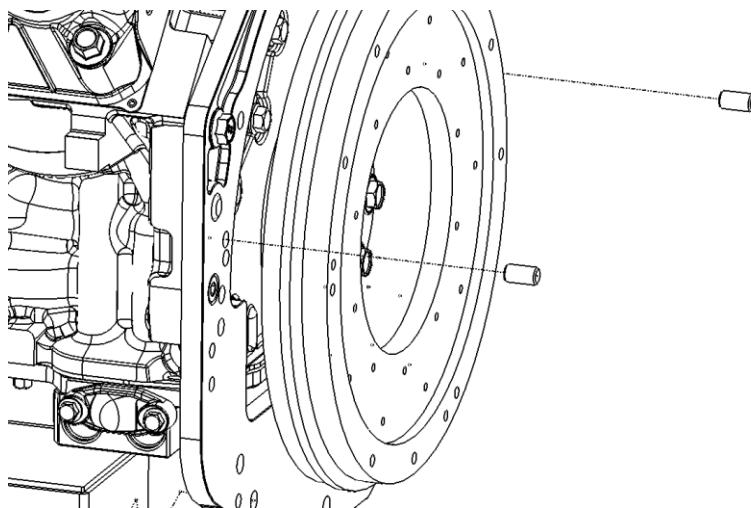

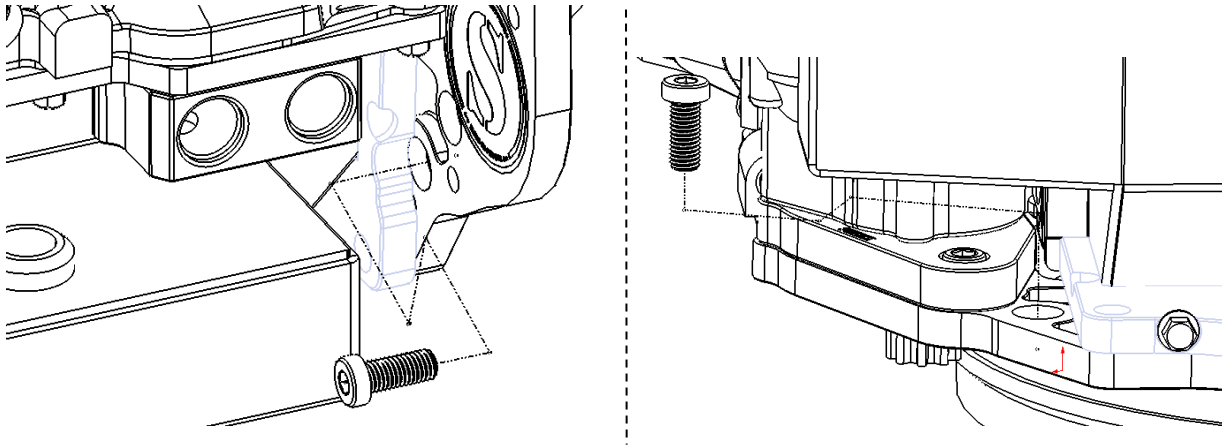

12. Insert the (2) M10-1.5 x 25mm Low Profile Button Head Cap Screws into the lower counterbored holes on the engine block side of the adapter plate and tighten. See images above.

13. Mount the CD009 transmission on the dowel pins and bolt it to the Adapter Plate.
Note: The transmission is shown cut to simplify the view of bolt locations.

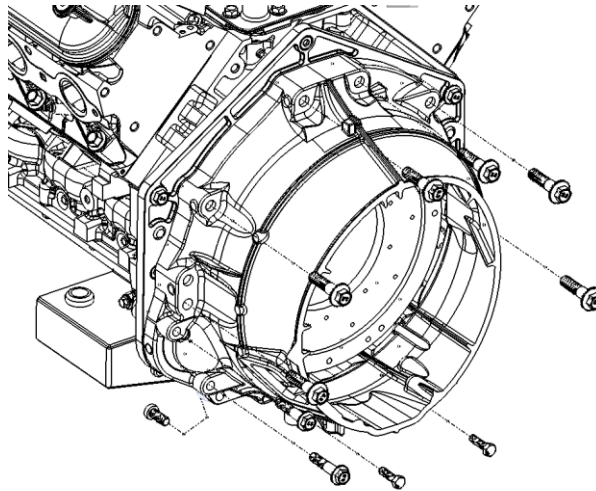

Install the (5) M12x1.75 x 50mm Flanged Hex Head Bolts in the upper holes of the transmission and adapter plate using a 16mm socket. Image below

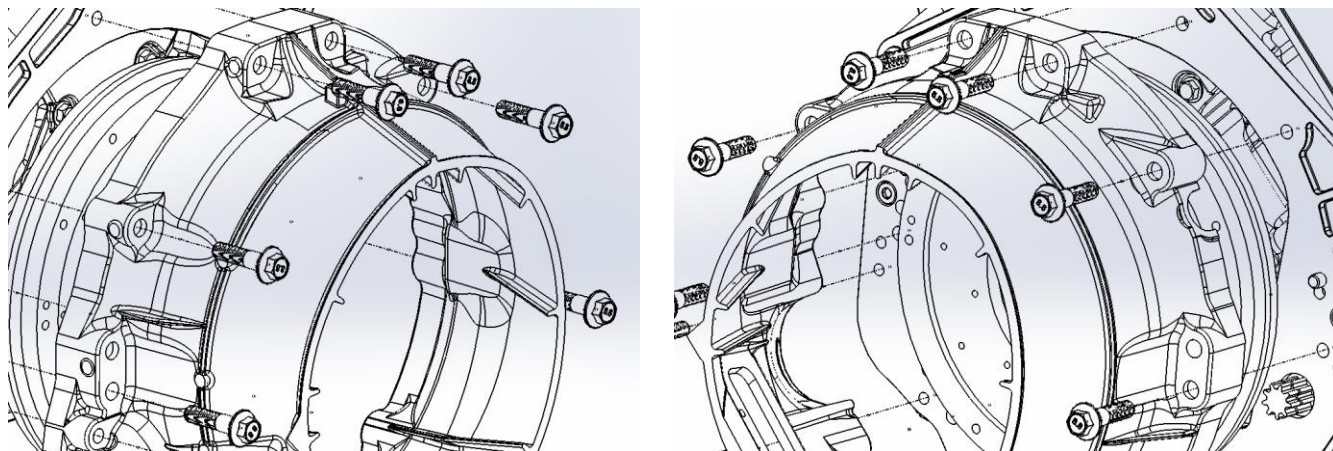

Install the (2) M10x1.5 Flanged Hex Head Bolts in the two holes on the left side of the transmission using a 15mm socket.

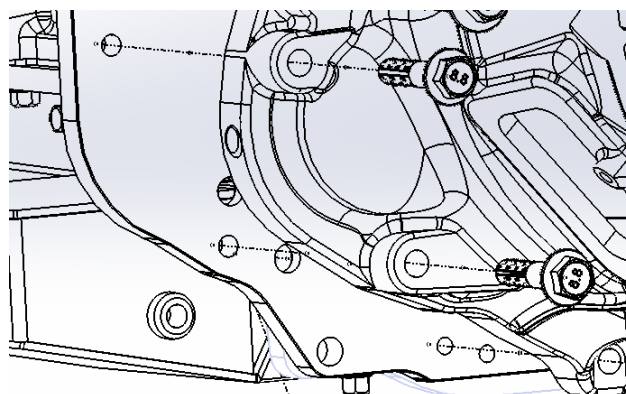

Install the (2) M8x1.25 Hex Head Bolts through the bottom two holes of the transmission into the adapter plate using a 13mm socket.

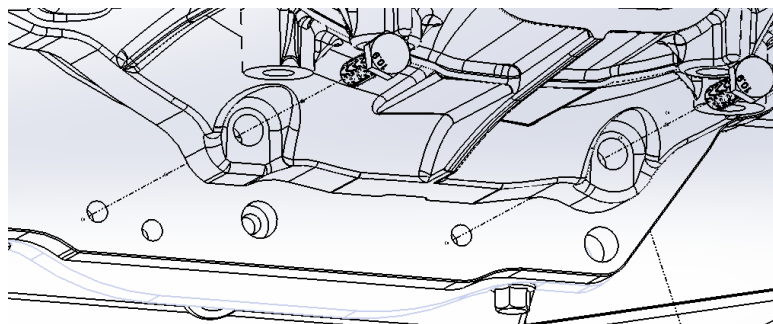

14. Finally check and tighten all hardware. ENJOY!!!

